

## BDC-955

Dust collector

Technical data	
Dimensions W / L / H	820 x 1980 x 1480mm
Weight	552kg
Motor power	5,5kW / 400 V / 50Hz & 60Hz / 63A / 5 pole CE plug
Dust extraction motors	2 powerful motors
Filter	9 high quality cartridge filters
Cleaning	Automatic pulse cleaning system
Dutbag capacity	100kg
Dust hose inlet	127mm / 150mm
Suitable machines	All large Blastrac machines.

### Options



Cartridge filter

Options / Accessories	
15m suction hose Ø127mm	492019
20m suction hose Ø150mm	001112
Dustbin kit complete	E07246
Cartridge filter	E10218
Big Bag	E06311
Other tools	On Request



Dust hose

### The innovators in surface preparation!!!!



Easy replaceable filters

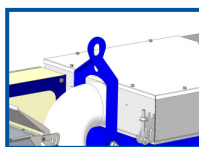

Central lifting point

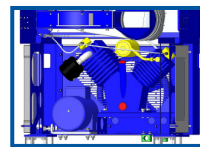

Separate compressor motor

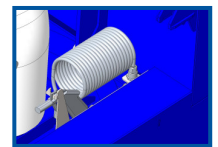

On-board air pistol

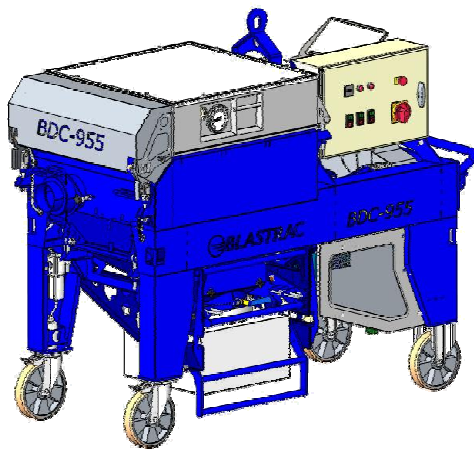

### Main assets

- ❖ Big bag system, easy and quick to replace.
- ❖ On-board air pistol for cleaning purposes.
- ❖ Suitable for 127mm and 150mm dust hose.
- ❖ Continuously working even while changing the big bag.
- ❖ 32A and 63A outlet sockets to connect to a wide range of Blastrac machines.
- ❖ Easy replaceable filters.
- ❖ Sound damping air outlet with integrated air flow control.
- ❖ Built according to the latest CE regulations. Certificate delivered with every machine.
- ❖ Automatic drain on water separator with space for bucket to capture water.
- ❖ Fan and compressor are able to be switched on and off separately, this enables a more effective cleaning of the filters, without having to run the fan unit.
- ❖ Central lifting point, for easy transport.